

EK-Quantum Scalar² Direct Link Side Port Terminal – Acetal

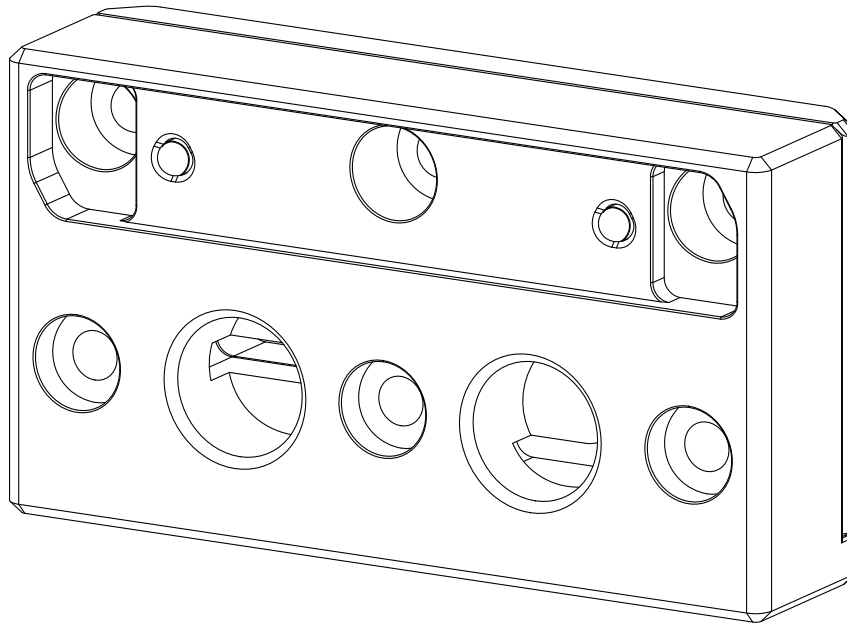

Please note the installation of the product is intended to be undertaken by an adequately trained and experienced person. You are installing the product at your own risk. If you are not properly trained or experienced or feel unsure about the installation procedure, please refrain from installing the product yourself and contact our tech support for assistance. We disclaim our liability for any damages to the product as well as incidental, consequential, or indirect damages incurred due to improper or inappropriate installation.

Before you start using this product, please follow these basic guidelines:

Carefully read the manual before beginning with the installation process.

Remove your graphics card from the computer for the safest mounting process to prevent any possible damage to your GPU or its circuit board (PCB).

The EK Fittings require only a small amount of force to screw them firmly in place since the liquid seal is ensured by the rubber O-ring gaskets.

TABLE OF CONTENTS

BOX CONTENTS	4
PRODUCT DIMENSIONS	5
TECHNICAL SPECIFICATIONS AND MAIN PARTS	6
INSTALLING THE EK-Quantum Scalar² Direct Link Side Port Terminal	6
FITTINGS AND TUBING	10
TESTING THE LOOP	10
WARRANTY	11
SUPPORT AND SERVICE	12
SOCIAL MEDIA	12

BOX CONTENTS

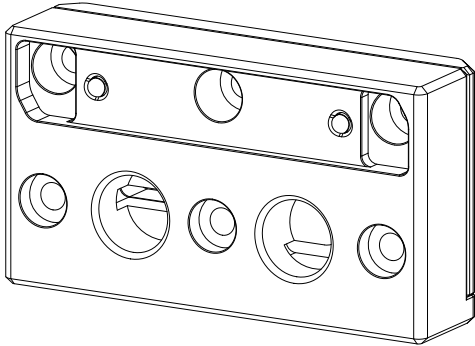

EK-Quantum Scalar² Direct Link Side Port Terminal - Acetal

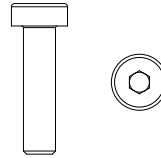

Screw M4 x 16 DIN7984 (3 pcs)

PRODUCT DIMENSIONS

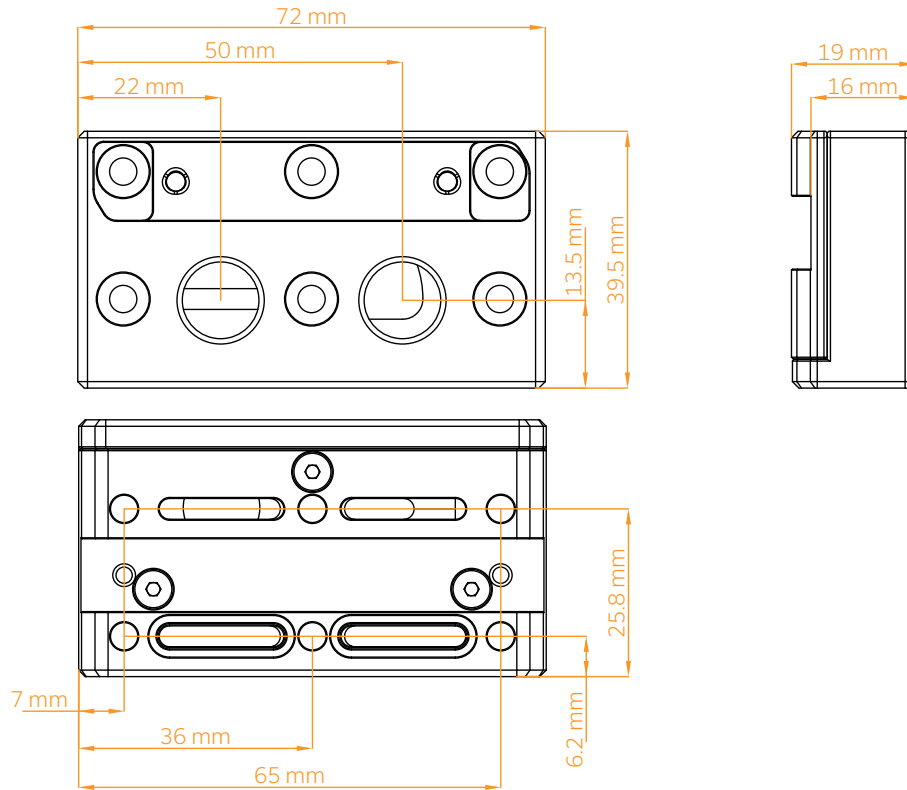

TECHNICAL SPECIFICATIONS AND MAIN PARTS

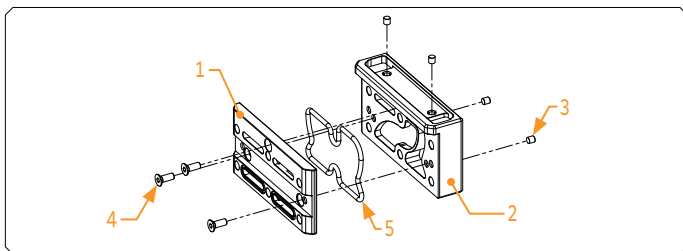

Product dimensions: 72 x 39.5 x 19 mm

Position	Code	Name	Quantity
1	105909	Terminal Base (Ni)	1
2	105907	Terminal - Block (Acetal)	1
3	104216	Disc magnet 3 x 3	4
4	8208	Screw M3 x 8 7991DIN	3
5	5008	OR 52 x 1.5 mm	1

INSTALLING THE EK-Quantum Scalar² Direct Link Side Port Terminal

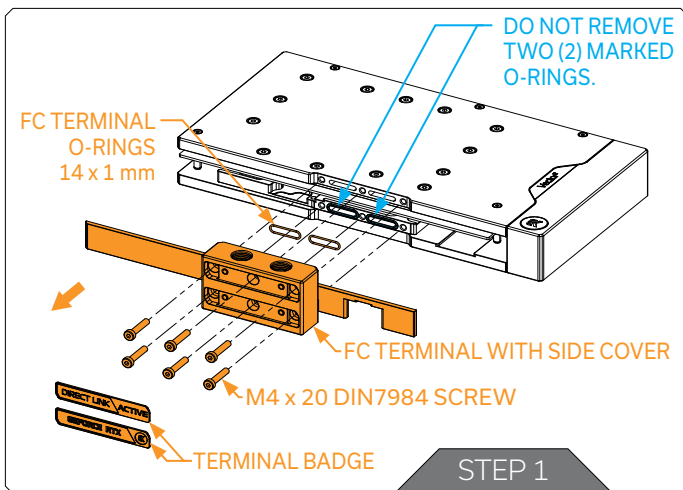

Important! Before starting, make sure to have a clean, flat surface to work on. It is recommended to put foam or soft material to lay the graphics card on. If the water block is filled with liquid, make sure to drain it before installing the Side Port Terminal.

STEP 1

Detach two (2) terminal badges (the terminal badge is attached with two (2) magnets)). Unscrew the pre-installed terminal together with the side cover and two (2) Terminal O-rings from the water block using the Allen Key 2.5 mm. Save the parts for later use.

DO NOT REMOVE TWO (2) MARKED O-RINGS.

For this step, you will need:

Allen Key 2.5mm



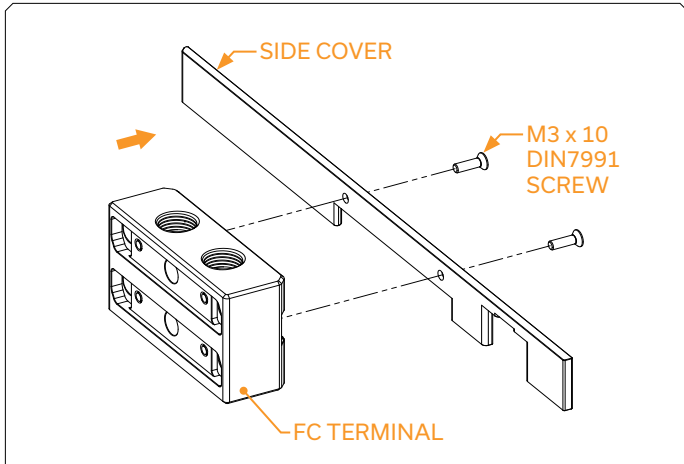

STEP 2

From the FC terminal, unscrew two (2) M3 x 10 DIN7991 Screws and detach the side cover.

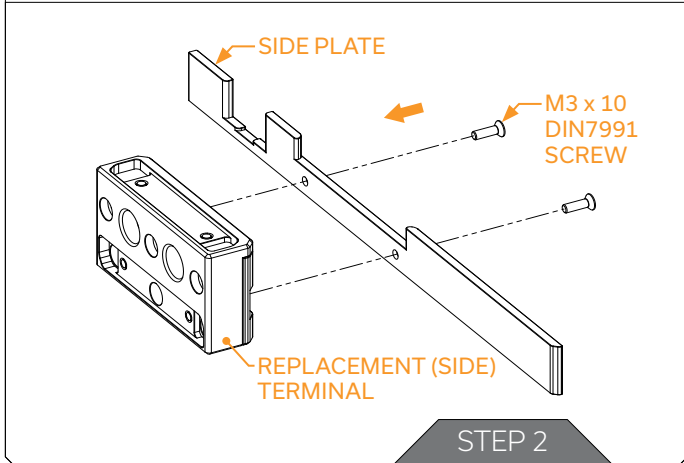

Reuse the side cover and M3 x 10 DIN7991 Screws and tighten them on the replacement (side) terminal.

STEP 2

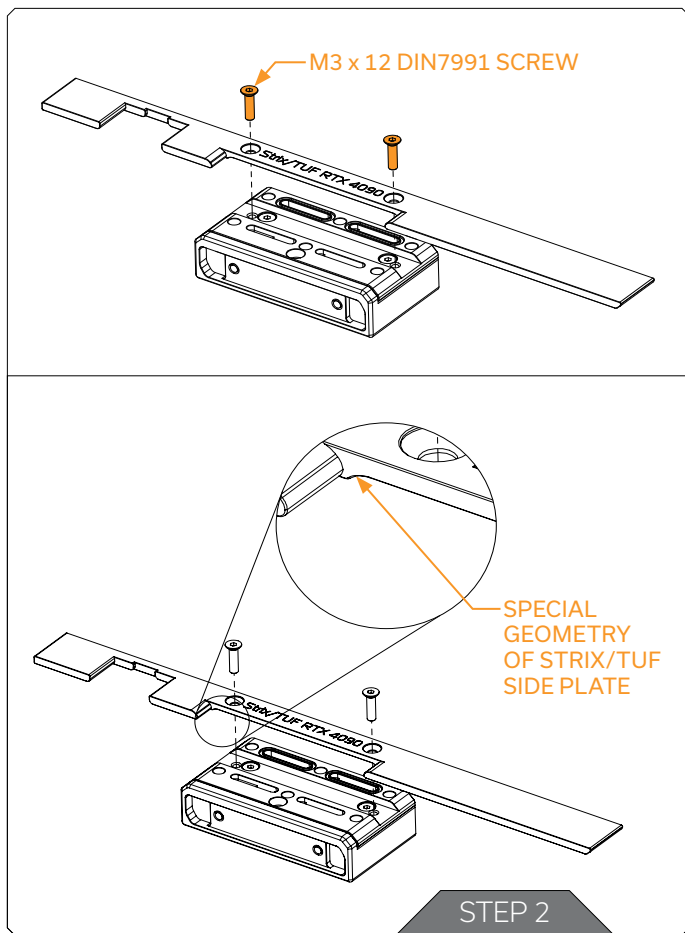

Using the Direct Link Side Port Terminal with EK-Quantum Vector² Strix/TUF ABP Set.

Two (2) M3 x 12 mm screws that are used to install the side plate do not require excessive force!

While mounting the EK-Quantum Vector² Strix/TUF version of the water block, please keep in mind that excessive force will end up bending the Strix/TUF Side plate. It has unique geometry to fit the Active Backplate Set.

Be advised that EK-Quantum Vector² Strix/TUF ABP Set along with EK-Quantum Scalar² DirectLink Side Port Terminal will NOT be Matrix-7 standard compliant!

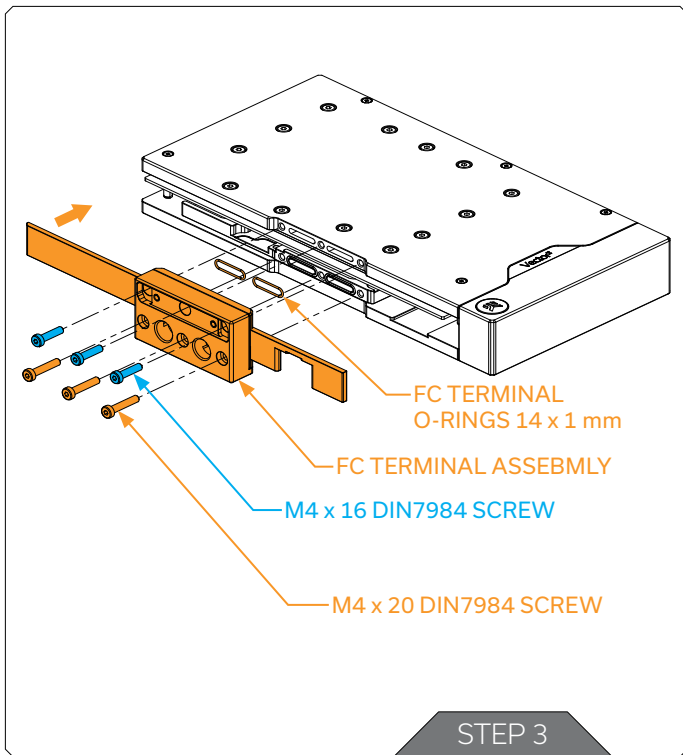

STEP 3

Place two (2) Terminal O-rings into the terminal slots and position the replacement terminal assembly on the water block. During this process, make sure you have aligned the holes.

Secure the terminal with three (3) M4 x 16 DIN7984 and M4 x 20 DIN7984 Screws. The saved terminal badges can be reused, after securing the replacement terminal.



Make sure that the cold plate and terminal O-rings stay in the slot before attaching the terminal!

For this step, you will need:

<p>Allen Key 2.5 mm</p>	<p>M4 x 16 DIN7984 Screw</p>	<p>M4 x 20 DIN7984 Screw</p>
<p>FC Terminal OR 14 x 1 mm (2 pcs)</p>	<p>Terminal Badge (2 pcs) (Optional)</p>	<p>FC Terminal Assembly</p>

FITTINGS AND TUBING

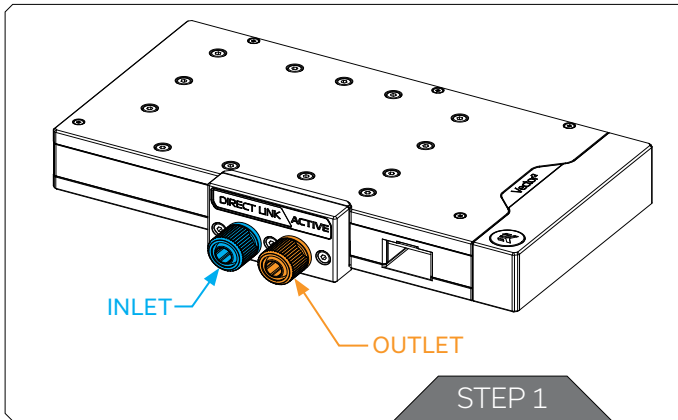

STEP 1

Screw in two (2) G1/4 threaded male fittings. Attach the liquid cooling tubes and connect the water block to the cooling loop.

EK recommends using EK fittings with all EK water blocks.



CAUTION: When using connectors other than EK fittings, pay special attention to the length of the fittings' male G1/4" thread - 5 mm is the maximum G1/4" thread length allowed!

TESTING THE LOOP

To make sure the installation of EK components was successful, we recommend you perform a leak test for 24 hours. When your loop is complete and filled with coolant, connect the pump to a PSU outside of your system. Do not connect power to any of the other components. Turn on the PSU and let the pump run continuously. It is normal for the coolant level to drop during this process as air collects in the distribution plate. Inspect all parts of the loop, and in the eventuality, that the coolant leaks, fix the issue and repeat the testing process. Ensure that all hardware is dry before the system is powered on to prevent any damage.

WARRANTY

Our products are warranted against defects of materials and quality for a period of 24 months, starting with the date of delivery to the end user. During this period, products will be repaired or have parts replaced at our discretion, provided that 1) the product is returned to the agent from whom it was purchased; 2) the product has been purchased by the end-user and has not been used for commercial purposes; 3) the product has not been misused, handled carelessly, or used in a manner other than the way described in the instruction's manual. This warranty does not confer rights other than those expressly set out above and does not cover any claims for consequential loss or damage. This warranty is offered as an extra benefit and does not affect your statutory rights as a consumer. This warranty is voided if the product comes in contact with aggressive UV additives or other improper liquids. EK Water blocks are sealed with a warranty-voiding circular label, proving the water block has withstood a pressure leak test. Removing the label will void the leak-free guarantee, but not the guarantee on the product itself. Any other RMA issues can be reported to EK Customer Support at www.ekwb.com/support for further analysis.

SUPPORT AND SERVICE

In case you need assistance or wish to order spare parts or a new mounting mechanism, please contact:

<https://www.ekwb.com/customer-support/>

For spare parts orders, refer to the page with "TECHNICAL SPECIFICATIONS AND MAIN PARTS" where you can find the EAN number of each part you might need.

Include the EAN number with quantity in your request.

SOCIAL MEDIA

 EKWaterBlocks

 @EKWaterBlocks

 ekwaterblocks

 EKWBofficial

 ekwaterblocks

